

Disclaimer of Information:

Contractor hereby agrees that the transfer of electronic media is furnished only for convenience and Contractor uses the information at its sole risk.

The information contained in the document is deemed to be correct however all information including dimensions and square footages contained in the document are approximate. It is the responsibility of the contractor to independently confirm dimensions and square footages based on field conditions.

Architect makes no representation as to the locations of utilities. All information regarding utility locations shall be ascertained by others from the landlord or tenant.

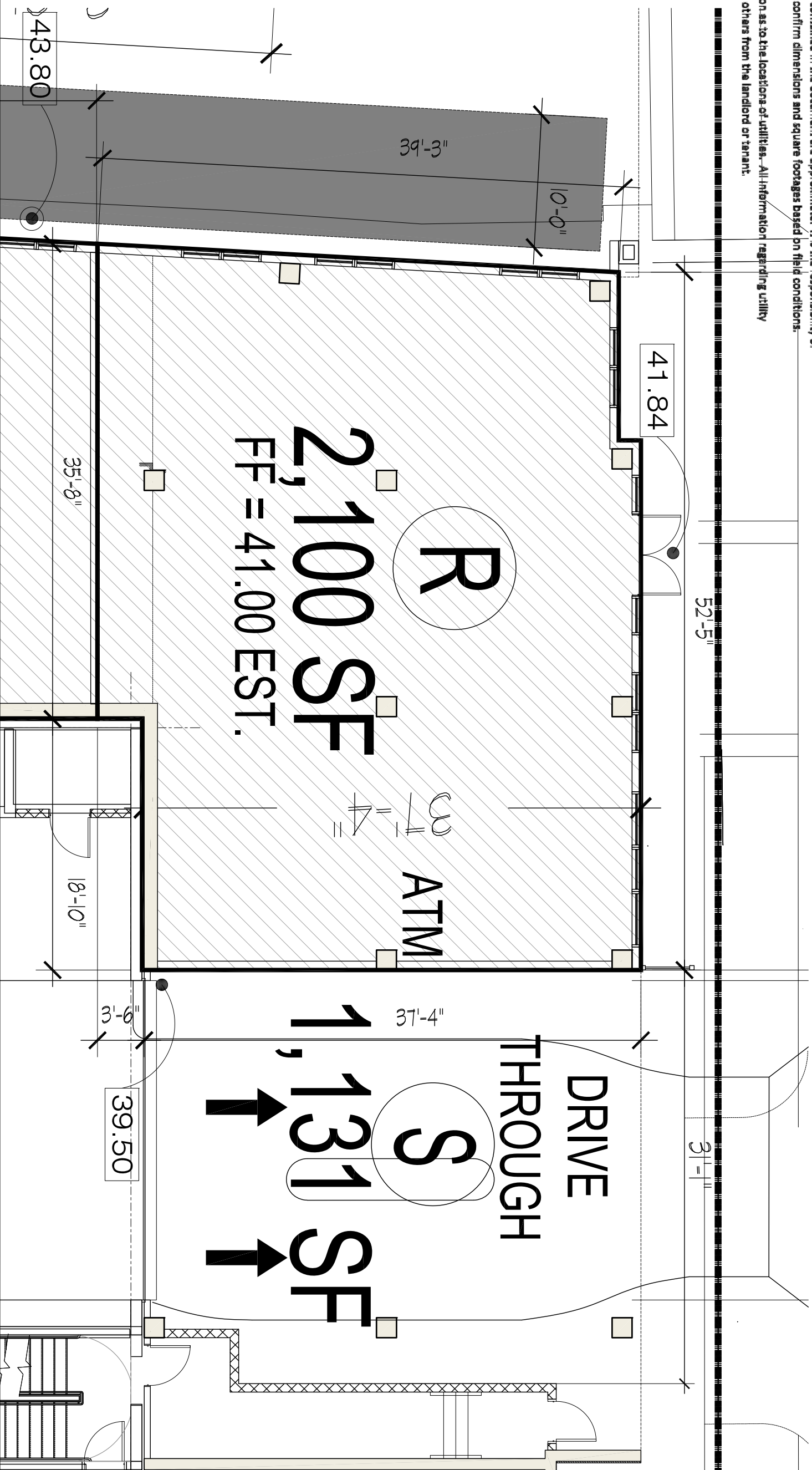

ARCHITECT
GOODING ARCHITECTURE
WWW.GOODINGARCHITECTURE.COM
135 BEDFORD ST. STE 202
STAMFORD CT 06901

PROJECT
The Waypointe - Retail Spaces

NORWALK, CT

DRAWING TITLE
**The Waypointe
Retail Address Plan
Space 'R'**

DATE REV. 1
11/09/2016
SCALE
1/8" = 1'-0"
DRAWING NUMBER
L-027